

Mark 9E. 197 c.c. Two-stroke Motor Cycle Engine

1. GEARBOX SHELL
2. BEARING, BALL
3. SEAL, OIL
4. DISTANCE PIECE, FINAL DRIVE SPROCKET
5. SPROCKET
6. NUT, FINAL DRIVE SPROCKET
7. WASHER, DISHED
8. SCREW, FINAL DRIVE SPROCKET LOCKING
- 8a. WASHER, FINAL DRIVE SPROCKET LOCKSCREW
9. DISC, LAYSHAFT BUSH CAP
10. PLUG, OIL FILLER

11. WASHER, OIL FILLER AND DRAIN PLUG
12. PLUG, OIL DRAIN
13. WASHER, GEARBOX JOINT
14. BUSH, LAYSHAFT
15. STUD, GEARBOX END COVER
16. WASHER, GEARBOX END COVER STUD
17. NUT, GEARBOX END COVER STUD
18. FORK, GEAR CHANGE SELECTOR
19. PLUNGER, GEAR SELECTOR

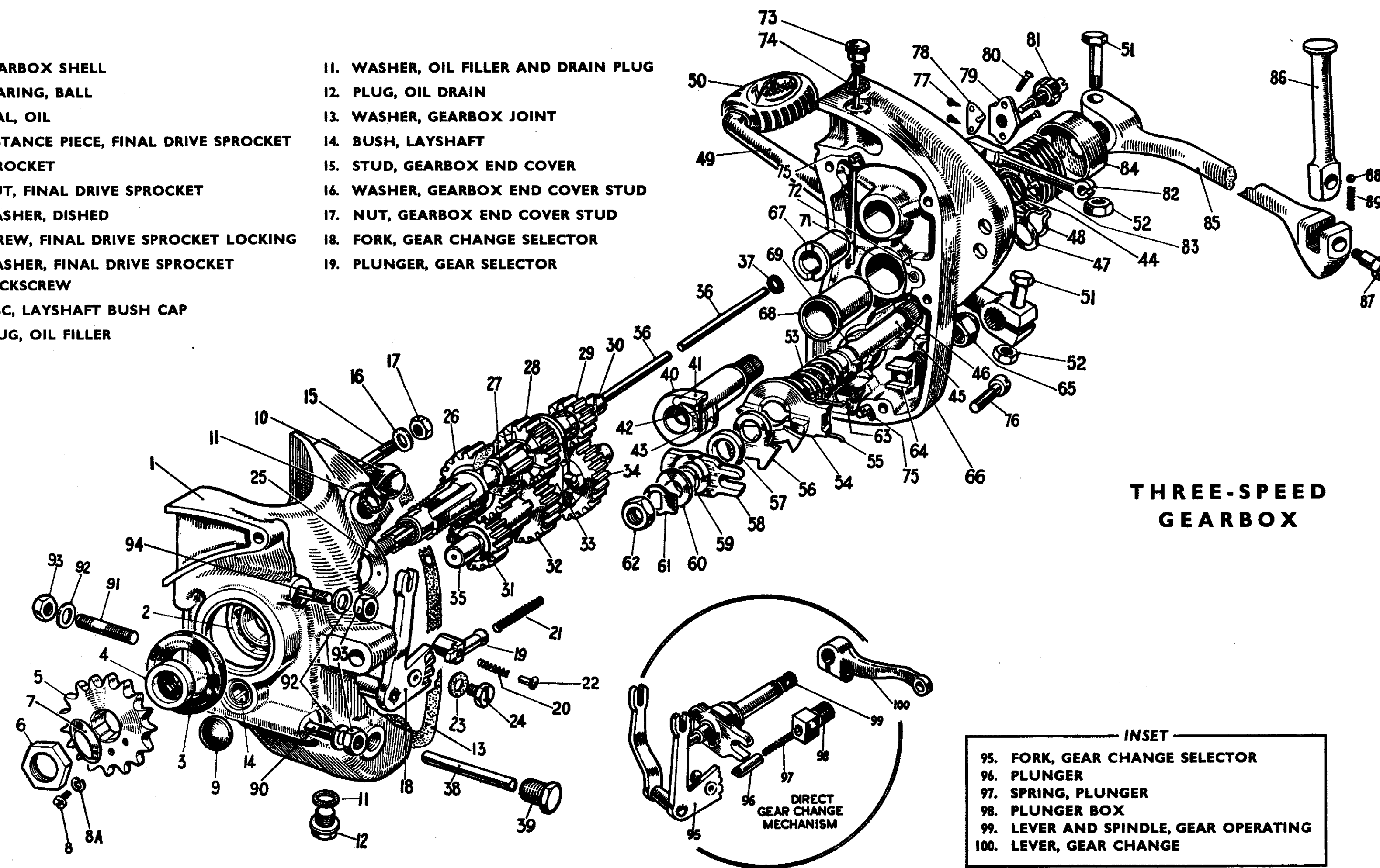

THREE-SPEED
GEARBOX

- INSET
95. FORK, GEAR CHANGE SELECTOR
 96. PLUNGER
 97. SPRING, PLUNGER
 98. PLUNGER BOX
 99. LEVER AND SPINDLE, GEAR OPERATING
 100. LEVER, GEAR CHANGE

20. SPRING, SMALL, GEAR SELECTOR PLUNGER
21. SPRING, LARGE, GEAR SELECTOR PLUNGER
22. PAD, GEAR SELECTOR PLUNGER SPRING
23. WASHER, OIL LEVEL SCREW
24. SCREW, OIL LEVEL
25. WASHER, BEARING SEALING
26. PINION, HIGH GEAR
27. WASHER, MAIN SHAFT PRESSURE
28. PINION, MAINSHAFT, SLIDING
29. PINION, MAINSHAFT, FIXED
30. MAINSHAFT
31. PINION, LAYSHAFT, FIXED
32. PINION, LAYSHAFT, SLIDING
33. OPERATOR, SLIDING GEAR
34. PINION, KICKSTART RATCHET LAYSHAFT
35. ROD, PUSH, CLUTCH OPERATING
36. WASHER, PUSH ROD SEALING
37. PIN, PIVOT, GEAR SELECTOR FORK
39. HEAD, SELECTOR PIVOT PIN

40. SHAFT, KICKSTART, BUSHED
41. PAWL, KICKSTART
42. PLUNGER, KICKSTART PAWL
43. SPRING, PLUNGER
44. RING, SEALING, KICKSTART SHAFT
45. SPINDLE, GEAR CHANGE OPERATING
46. RING, SEALING, OPERATING SPINDLE
47. WASHER, SEALING RING RETAINING
48. CIRCLIP, WASHER RETAINING
49. LEVER, GEARCHANGE, FOOT OPERATED
50. RUBBER, GEARCHANGE LEVER
51. BOLT, GEARCHANGE AND KICKSTART LEVERS
52. NUT, GEARCHANGE AND KICKSTART LEVERS
53. SPRING, GEAR OPERATING PAWL
54. PAWL, GEAR OPERATING
55. SPRING, RETURN, GEAR OPERATING PAWL
56. DOWEL, GEAR OPERATING SPINDLE
57. DISTANCE PIECE, OPERATING SPINDLE

58. LEVER, GEAR OPERATING SPINDLE
59. SHIM, GEAR OPERATING SPINDLE
60. WASHER, GEAR OPERATING SPINDLE
61. WASHER LOCKING, OPERATING SPINDLE NUT
62. NUT, LOCKING, OPERATING SPINDLE
63. PIN, STOP, GEAR OPERATING PAWL
64. BOX, PLUNGER
65. NUT, PLUNGER BOX
66. COVER, GEARBOX END
67. BUSH, MAINSHAFT
68. BUSH, KICKSTART SHAFT
69. BUSH, GEAR OPERATING SPINDLE
71. SCREW, KICKSTART STOP
72. STOP, KICKSTART RETURN
73. DIPSTICK AND KNOB
74. WASHER, DIPSTICK
75. DOWEL, GEARBOX END COVER
76. SCREW, GEARBOX END COVER

77. SCREW, CLUTCH ADJUSTER LOCKING PLATE
78. PLATE, CLUTCH ADJUSTER LOCKING
79. BRIDGE, CLUTCH LEVER
80. SCREW, CLUTCH BRIDGE
81. SCREW, CLUTCH ADJUSTER
82. LEVER, CLUTCH
83. SPRING, KICKSTART RETURN
84. CAP, KICKSTART RETURN SPRING
85. LEVER, KICKSTART
86. PEDAL, KICKSTART LEVER
87. PIN, KICKSTART LEVER PEDAL PIVOT
88. BALL, KICKSTART LEVER PEDAL
89. SPRING, KICKSTART LEVER PEDAL BALL
90. STUD, GEARBOX FIXING, BOTTOM LEFT-HAND
91. STUD, GEARBOX FIXING, BOTTOM, RIGHT-HAND
92. WASHER, GEARBOX FIXING STUD NUT
93. NUT, GEARBOX FIXING
94. STUD, GEARBOX FIXING, TOP

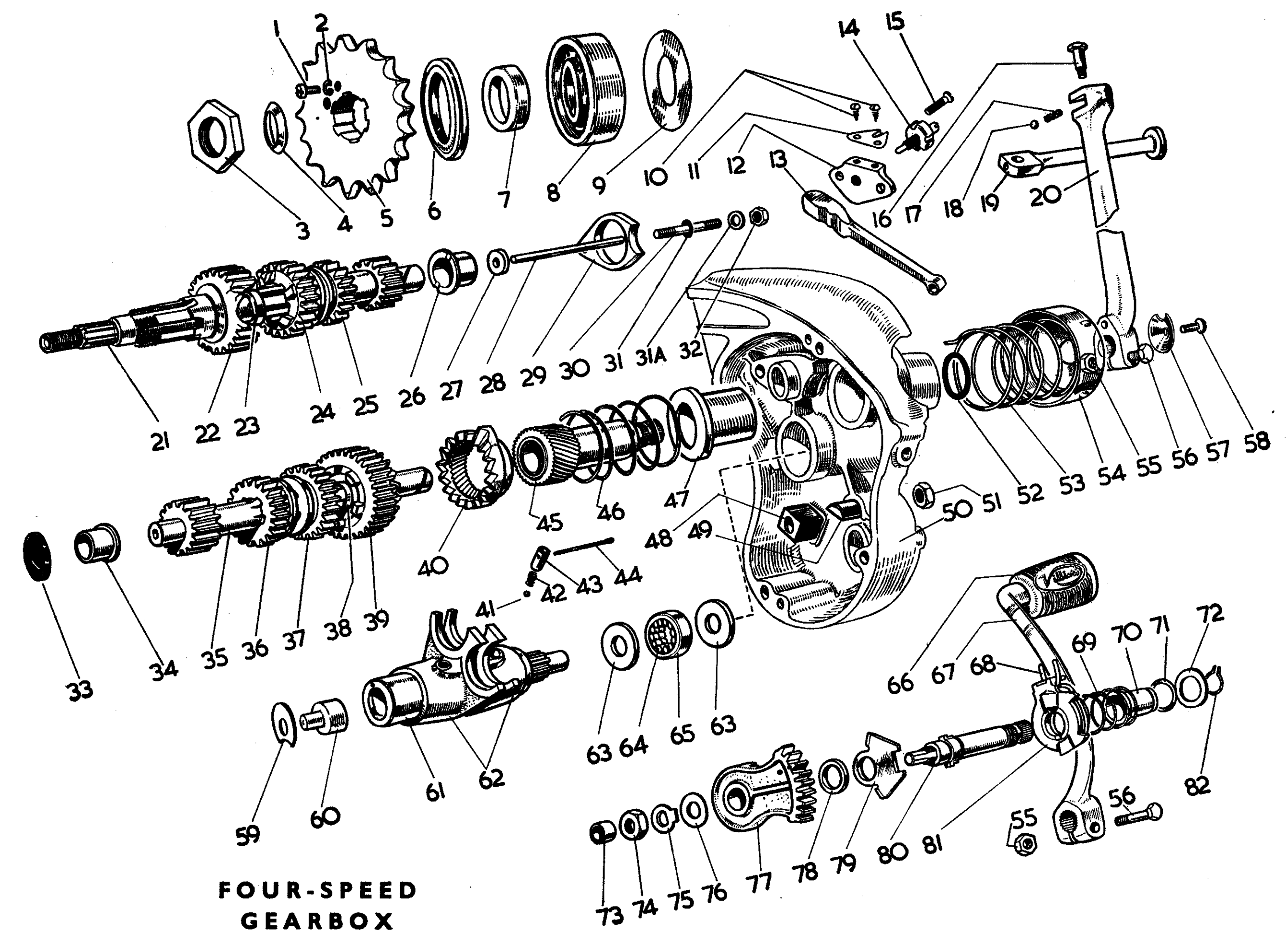

FOUR-SPEED
GEARBOX

1. SCREW, FINAL DRIVE SPROCKET NUT
2. WASHER, SPRING
3. NUT, FINAL DRIVE SPROCKET
4. WASHER, DISHED
5. FINAL DRIVE SPROCKET
6. SEAL, OIL
7. DISTANCE PIECE
8. BEARING, BALL
9. SHIM, BEARING SEALING
10. SCREW, LOCKING PLATE
11. CLUTCH ADJUSTER LOCKING PLATE
12. CLUTCH BRIDGE
13. CLUTCH LEVER
14. SCREW, CLUTCH ADJUSTER
15. SCREW, CLUTCH BRIDGE
16. KICKSTART PEDAL PIVOT PIN
17. KICKSTART PEDAL SPRING
18. KICKSTART PEDAL BALL
19. KICKSTART PEDAL
20. KICKSTART LEVER
21. MAINSHAFT, WITH INTEGRAL GEAR
22. HIGH GEAR PINION
23. PRESSURE WASHER
24. SLIDING GEAR WITH DOGS, MAINSHAFT
25. SLIDING GEAR WITHOUT DOGS, MAINSHAFT
26. BUSH, MAINSHAFT
27. WASHER, PUSH ROD SEALING
28. CLUTCH, PUSH ROD
29. KICKSTART RATCHET STOP
30. STUD, CLUTCH BRIDGE

31. SEALING RING
- 31a. WASHER, CLUTCH BRIDGE
32. NUT, CLUTCH BRIDGE
33. DISC, LAYSHAFT BUSH CAP
34. BUSH, LAYSHAFT
35. LAYSHAFT, WITH INTEGRAL GEAR
36. SLIDING GEAR, WITHOUT DOGS, LAYSHAFT
37. SLIDING GEAR, WITH DOGS, LAYSHAFT
38. PRESSURE WASHER
39. RATCHET PINION, KICKSTART
40. KICKSTART RATCHET
41. BALL, SLIDING GEAR FORK PEG
42. SPRING, SLIDING GEAR FORK PEG
43. PEG, SLIDING GEAR FORK
44. SPLIT PIN, PEG AND SPRING RETAINING
45. KICKSTART SHAFT
46. KICKSTART RATCHET SPRING
47. BUSH, KICKSTART SHAFT
48. STOP, GEAR CHANGE RETURN SPRING
49. STOP PIN, GEAR OPERATING PAWL
50. GEARBOX END COVER
51. NUT, GEARCHANGE SPRING STOP
52. SEALING RING, KICKSTART SHAFT
53. KICKSTART RETURN SPRING
54. KICKSTART RETURN SPRING CAP
55. NUT, KICKSTART AND FOOT CHANGE PEDAL
56. BOLT, KICKSTART AND FOOT CHANGE PEDAL
57. KICKSTART SHAFT COVER WASHER
58. KICKSTART SHAFT COVER WASHER SCREW

59. THRUST WASHER, CAM BARREL
60. BEARING PIN, CAM BARREL
61. CAM BARREL WITH STOP PEG
62. SLIDING GEAR FORK
63. CAM BARREL BEARING THRUST WASHER
64. ROLLERS, CAM BARREL BEARING
65. CAM BARREL BEARING OUTER RACE
66. GEAR CHANGE LEVER RUBBER
67. GEAR CHANGE LEVER
68. GEAR OPERATING PAWL RETURN SPRING
69. GEAR CHANGE RATCHET SPRING
70. BUSH, GEAR OPERATING SPINDLE (END COVER)
71. OIL SEAL, GEAR OPERATING SPINDLE
72. WASHER, OIL SEAL RETAINING
73. BUSH, GEAR OPERATING SPINDLE
74. NUT, GEAR OPERATING SPINDLE
75. LOCKWASHER, GEAR OPERATING SPINDLE
76. SHIM, GEAR OPERATING SPINDLE
77. GEAR OPERATING QUADRANT
78. DISTANCE PIECE
79. GEAR OPERATING SPINDLE PLATE
80. GEAR OPERATING SPINDLE
81. GEAR OPERATING PAWL
82. CIRCLIP, GEAR OPERATING SPINDLE

★ See Sheet V.E.C. 504 for Mark 9E Engine, Crankshaft Assembly and Clutch, and Sheet V.E.C. 506 for Mark 9E Magneto and Carburettor.